

This home may have been altered from the plan's original design.

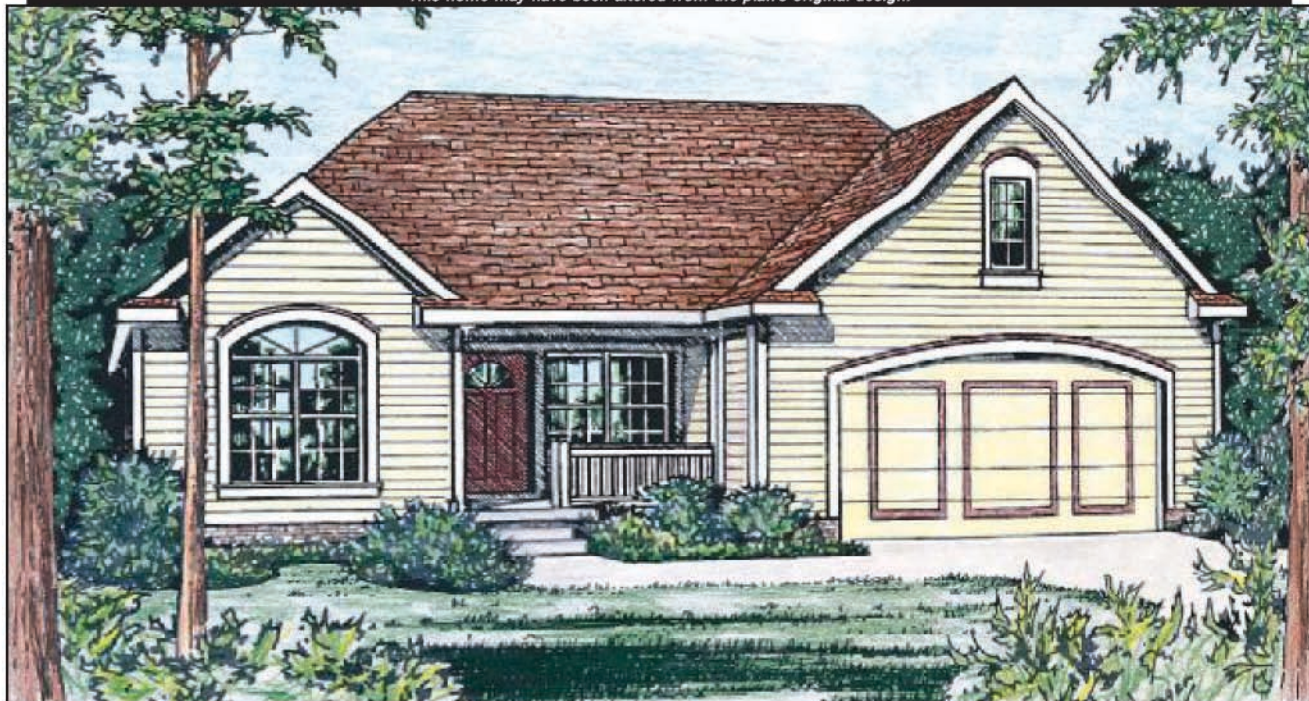

Great room features fireplace flanked by windows

Two steps up from the great room, an angled dining area is bright and sunny and offers access to a covered porch

Corner windows and a boxed ceiling adorn the master bedroom, served by a private bath with walk-in closet

Secondary bedrooms share a full bath

Wrapping counters and a corner pantry add convenience in the kitchen

Unfinished area on the second level offers room to expand

9 foot high main level walls

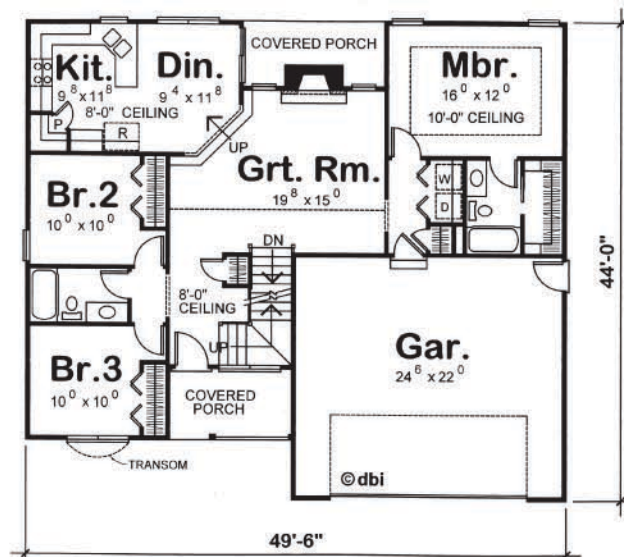

Unfinished Storage
Adds 342 Square Feet

