

This home may have been altered from the plan's original design.

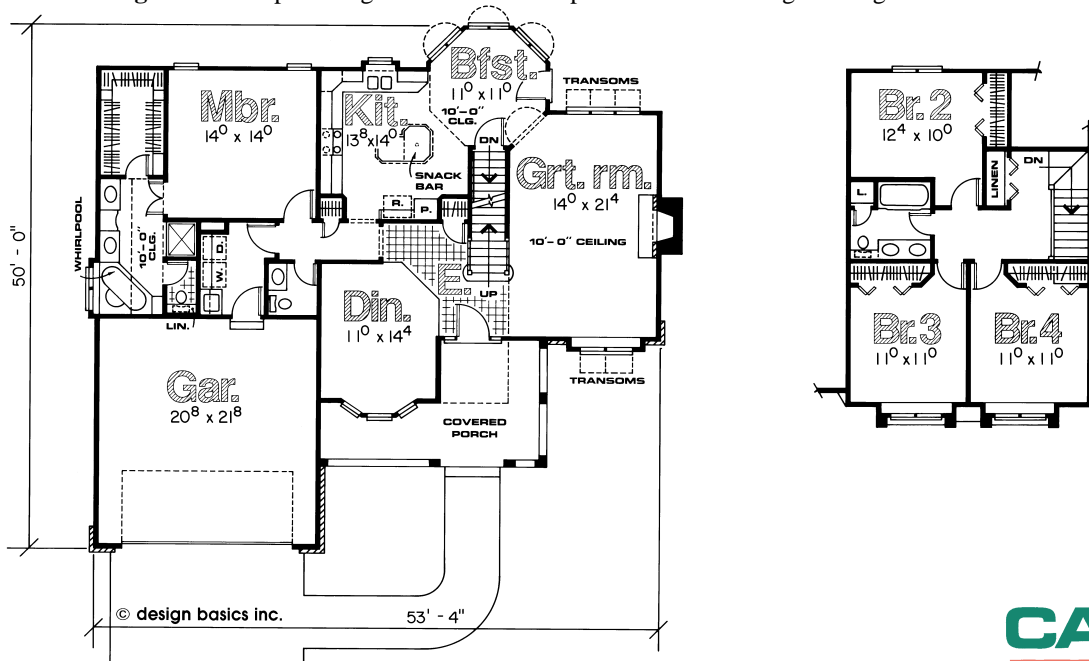

- Covered porch, bayed window, column details** accent this 1½ story home
- 1,414 sq. ft. on main level, 641 sq. ft. upstairs**
- Octagon-shaped breakfast area** is enhanced by arched transom windows
- Master suite** offers large walk-in closet, dual lavs, whirlpool bath and shower area
- Efficient laundry** has convenient access from garage and kitchen
- Dual linen closets** serve upstairs hall bath with dual lavs
- Entry** reveals formal dining room and spacious great room with fireplace and 10-foot-high ceiling



Bring your plans to the store nearest you for a free material take-off and estimate.
 For location information use our store locator at www.carterlumber.com.